



PVP16 DESIGN SERIES 12 CHANGES

Parker Hannifin Corporation
Hydraulic Pump/Motor Division
100 Parker Drive
Otsego, Michigan 49078
Telephone: 616 694-9411
Fax: 616 694-4638

Design Series 12 Changes

1. Change housing machining to incorporate o-ring seal around trunnion pin versus gasket.
2. Change swashplate machining to use intergral hardened wear pin versus flame hardening process.
3. Change geometry on servo piston to match new swashplate contact point.

Interchangeability of Design 12 and Design 11 PVP16.

1. Design series 12 housing (788046) is totally interchangeable with design series 11 pumps.
2. Design series 12 swashplate (788014) will fit in design series 11 pumps, but will only work with design series 12 servo piston (787943).

NOTE: When repairing a design 11 pump the swashplate and servo piston must be changed as a set.

3. The seal kit for a design 12 PVP16 (SKPVP16/12) is fully compatible with design 11 PVP16's.

PVP16 DESIGN 11	PVP16 DESIGN 12	PART NAME	DESCRIPTION OF CHANGE
786968	788046	Housing	Machine O-ring groove around trunnion area
787326	2022*-7	Gasket, O-ring	Change from gasket seal to O-ring seal (more positive seal)
787248	788014	Swashplate	Change from flame heat treated swashplate to installing hardened wear pin
786992	787943	Servo Piston	Changed to match swashplate contact point

PVP16 Design Series 11

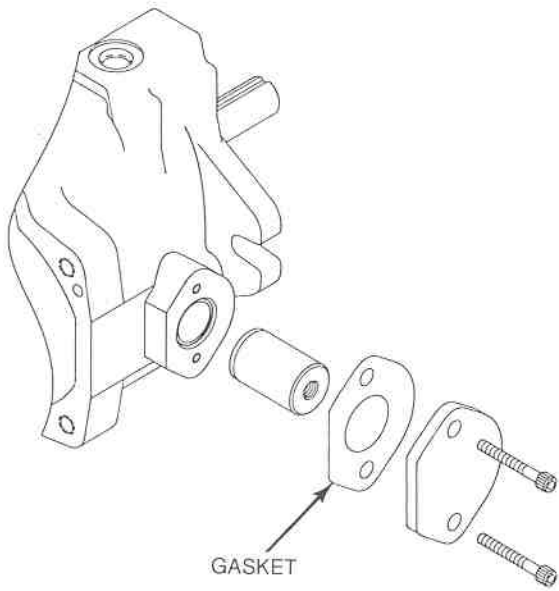

PVP16 Design Series 12

